

eXlerate[®] SUPERVISORY SOFTWARE

MEASUREMENT AUTOMATION SOFTWARE





Introduction.....	3
Designed for our industry.....	4
Key benefits	5
100% Redundancy	6
MMM: Mismeasurement Management	7
Scalable architectures	9
Service & support.....	10



DID YOU KNOW?

Since 2003, over 1200 eXLerate supervisory systems have been installed worldwide!

eXLerate is a software platform for flow metering supervisory systems within the oil and gas industry. It provides an automation solution for many market segments, such as custody transfer flow measurement in refineries and pipelines.

Even though solutions with common HMI/SCADA packages already exist, they lack essential functions for making control metering systems truly efficient and effective. As eXLerate is exclusively engineered for the oil and gas industry, it overcomes many generic systems' shortcomings.

eXLerate is the first of its kind to:

- ✓ *Properly **acquire and archive** all measurement data;*
- ✓ ***Monitor and control** the quality of measurement;*
- ✓ *Use its **smart device-potential** fully by checking its health, communicating it to other devices and providing additional fluid property information on its own;*
- ✓ *Apply **self-diagnostics** on both device and system level to warn the user in real-time for (upcoming) measurement issues;*
- ✓ *Automatically correct errors, by utilizing the newest **Mismeasurement Management-technology**.*

The need for accuracy, reliability and cost-effectiveness is high in the oil and gas industry; eXLerate lives up to the maximum requirements.



eXLerate system in operation, together with Spirit IT's Flow-X flow computers

DID YOU KNOW?

Because of its 100% redundancy system, eXLerate has an availability rate of 99,999%!

DESIGNED FOR OUR INDUSTRY

As eXLerate is developed specifically for the oil and gas industry, it has the most powerful set of integrated tools, functions, add-in libraries and applications.

As a standard, the following gas & liquid calculations are available in our software:

- ✓ AGA3, AGA5, AGA8, AGA10. Compliant with AGA7, AGA9, AGA11.
- ✓ API chapters 11.1, 11.2, 12.2, 21.1 and 21.2, API 2540, API 1952, 1980, 2004 tables (both metric and US versions).
- ✓ ISO 5167 (all editions), ISO 6976 (all editions), NX19, SGERG, GOST, PTZ, GERG2004, GERG2008.
- ✓ GPA 2172 / ASTM D3588, TP15, TP16, TP25, TP27.
- ✓ IAPWS-IF97 steam and water tables.
- ✓ NIST-1045 for Ethylene, API 11.3.2.1 Ethylene (API-2565).
- ✓ ASTM D1550.
- ✓ Time & flow weighted averages, periodic time series. Accurate period & accumulative totalizers and reporting.
- ✓ Linearization curves for correction of calibrated meters.
- ✓ Dynamic viscosity, isochoric heat capacity, isobaric heat capacity, isentropic exponent, energy, entropy, and many other data.

KEY BENEFITS



Clear visualization & animation

Information is presented in a multilingual & graphically animated environment.



Reliable security

Multiple security levels prevent accidental mistakes or unauthorized access.



Alarm management

A programmable summary with current & past alarms and events is available.



Clear data communications

All information is defined in one single worksheet, with support for almost any field device.



Trending

Customizable real-time and historical trending, which may be displayed in a single trend graph.



Custody transfer reporting

High-quality reports are fully integrated and may be automatically or manually generated.



Database storage

A database server is available with ready-to-use functions for easy integration and further analysis.

OPTIONAL FEATURES

- ✓ **Virtual Flow Computing (VFC) functionality with detailed diagnostics.**
- ✓ **Validation and calibration procedures, ensuing real-time verification of field devices.**
- ✓ **Control features of proving, sampling and batching.**
- ✓ **Ultrasonic and Coriolis diagnostics & performance monitoring and Condition Based Monitoring-technology.**
- ✓ **Virtual printer management: possibility of retrieval, storage, processing & printing of fiscal flow computer reports.**
- ✓ **For custody transfer applications, the unique functionality of 100% redundancy and Mismeasurement Management.**



Virtual Flow Computing Screen

100% REDUNDANCY

For custody transfer-specific systems, eXLerate is the first to ensure full availability with its 100% redundant system architecture.

With the use of multiple server computers, which synchronize and back-up all metering data, one point of failure will never lead to a total breakdown. Because our computers are capable of instantly taking over the role as Duty server in a 'bumpless' manner, data monitoring and control will never be interrupted.

As eXLerate software offers the highest degree of redundancy in its systems, full data transparency and maintainability is realized on all connected computers.

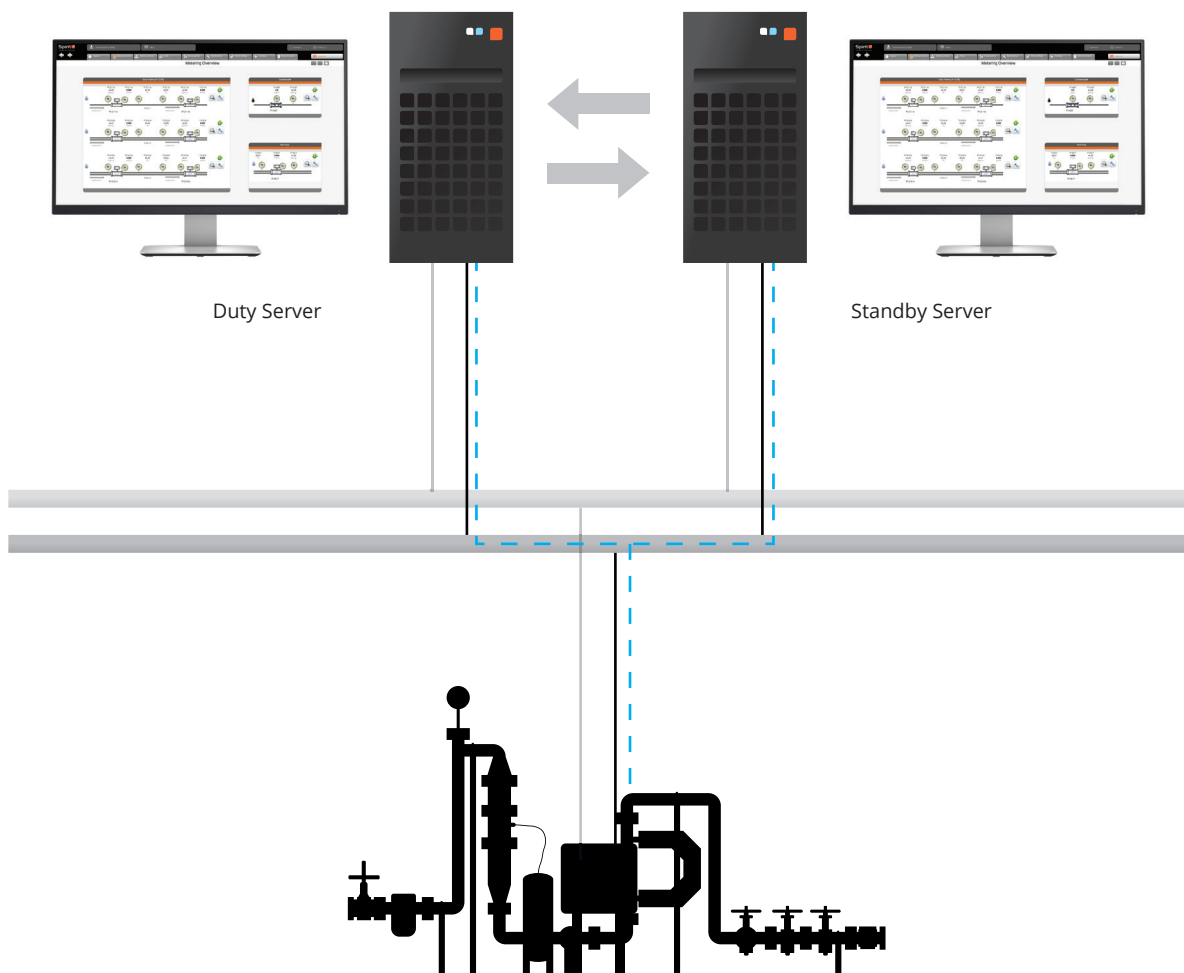

Our redundant configuration ensures 'bumpless' automatic switchovers from Duty to Standby

MMM: MISMEASUREMENT MANAGEMENT

Up to now, detecting and solving software measurement errors has been time-consuming, expensive and not done by default.

Spirit IT's innovative Mismeasurement Management technology finally overcomes this inefficiency. Being the first to automatically detect and resolve all mismeasurement issues in (near) real-time, this technology incorporates extensive methods varying from basic checks to sophisticated algorithms. Furthermore, it includes a highly accurate and patented method based on API MPMS Chapters 21.2 and 21.2, to improve system uncertainty.

THE MMM-TECHNOLOGY:

- ✓ *Detects errors as quickly as possible;*
- ✓ *Allows the user to efficiently analyze the issue;*
- ✓ *Corrects errors as precisely as possible;*
- ✓ *Facilitates automatic billing corrections;*
- ✓ *Is both time- and moneysaving.*



Due to its MMM-technology, eXLerate sets the highest standard in custody measurement

Operator Stations with Redundant Servers

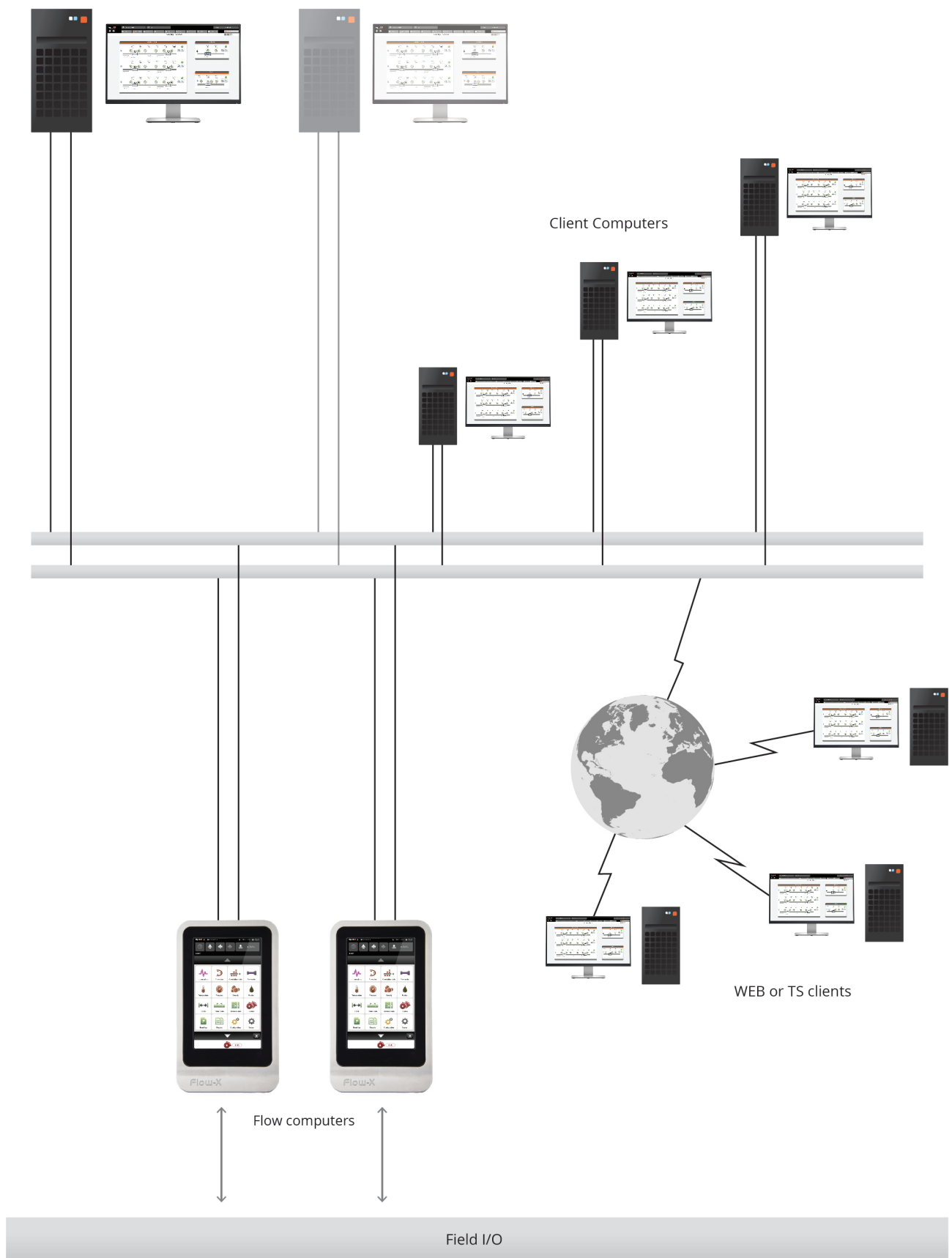

System architecture of an exLerate installation

SCALABLE ARCHITECTURES

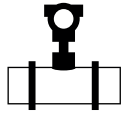

*Metering
Supervisory
& Control*



*Virtual Flow
Computing
Systems*

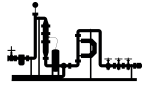

*LACT
Control*



*Pipeline
Network
Management*

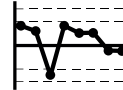

*Flow Calibration
Facility
Management*



*Terminal
Automation*

Not only is eXLerate compatible with a wide range of applications, its scalability makes it suitable for everything between small local supervisory and large corporate control systems.

In abundant facilities, one standalone eXLerate-based application is sufficient to create a solid, reliable HMI solution with more than adequate functionality.

However, for highly critical systems where stability and availability is essential, eXLerate also provides redundant system architectures.

Additionally, the system can be extended with multiple Client computers, which each act as fully functional operator station.

Highly scalable systems have the following advantages:

- ✓ **High flexibility** in I/O from and to devices;
- ✓ **Consistency in settings** as modifications are constantly updated;
- ✓ **Automatic synchronization** between operator commands and control logic.

DID YOU KNOW?

Our largest metering system installed consists of 19,000 I/O tags, based in Kuwait.

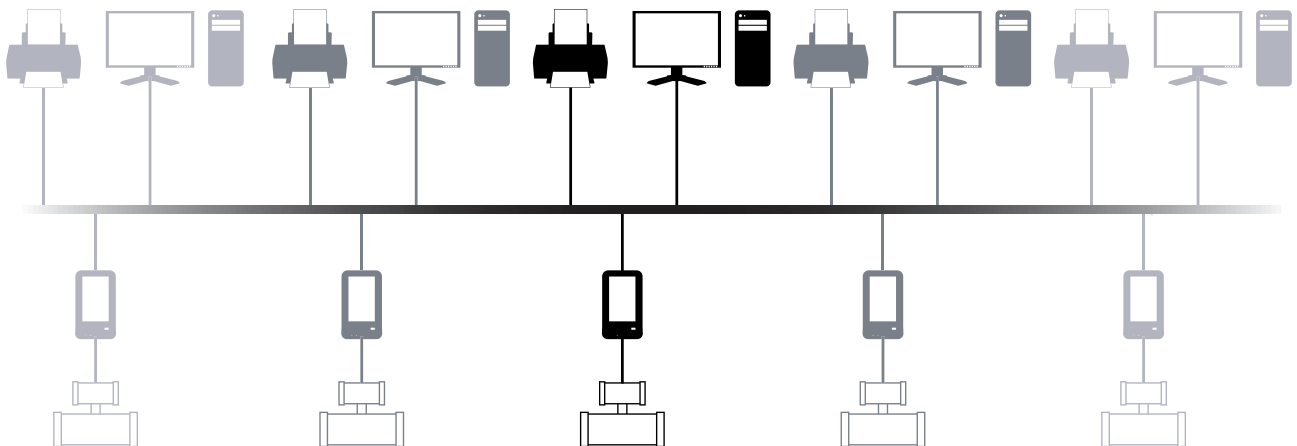

eXLerate is scalable from small local to large corporate systems

SERVICE & SUPPORT



Product licensing for integrators

System integrators may use eXlerate licenses for their own applications and projects. Engineering and consulting services can be provided on either a turnkey or project basis, including specific software development.



Training

In order to make users feel confident with our software, we provide customized operator training to turn them into eXlerate- and metering specialists.



Technical support

We provide life-cycle management services to support the work of system integrators and equipment manufacturers. Conducted by a global network of trained experts, this includes strategic cooperation, consultancy and total project management.

On-site installation support



Quick access to other functions

Real-time performance indicators



Advanced diagnostics for Ultrasonic & Coriolis flow meters

Diagnostics Screen

Parameter Error Trend

Instrument Control Chart



Statistical Control of Proved Meter Factors

Instrument Error Graph

Control Charts Screen

ABOUT SPIRIT IT

We make flow measuring systems **better, smarter and more accurate.**



A MEMBER OF THE ABB GROUP



Power and productivity
for a better world™

Since November 2014, Spirit IT has become a member of the ABB Group. The acquisition adds a new line of high-performance custody transfer solutions to ABB's measurement business unit.

ABB is a leader in power and automation technologies that improve performance while lowering environmental impact. With thousands of experts around the world and high-performance innovations, ABB's team is dedicated to making measurement easy for its customers.

WEB

www.SpiritIT.com

MAIL

sales@SpiritIT.com

EINDHOVEN

The Netherlands

*Prof Dr Dorgelolaan 20
5613 AM Eindhoven
The Netherlands*

*PO Box 2019
5600 CA Eindhoven
The Netherlands*

T +31 40 23 69 445

HOUSTON

United States of
America

*201 Kingwood
Medical Drive
Suite A200
Kingwood TX 77339
United States of
America*

T +12 81 97 31 740

KUALA LUMPUR

Asia Pacific/Malaysia

*Vista Tower, Suite 13D
Level 13
348 Jalan Tun Razak
50400 Kuala Lumpur
Malaysia*

T +60 3 2166 5266